

# WHITEWATER® *Attractions*

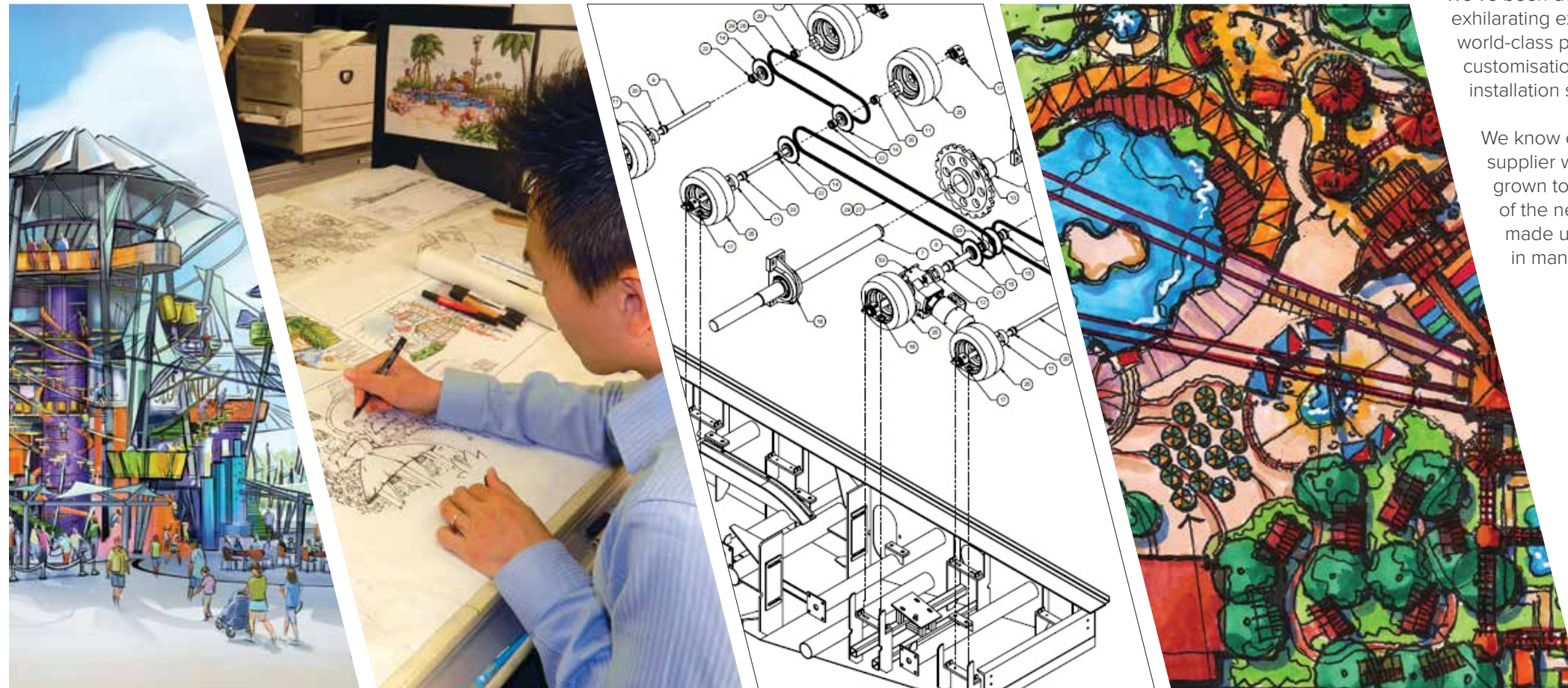



# A PARTNER FOR YOUR PARK'S SUCCESS



## WhiteWater Attractions: Design Excellence, WOW Water Rides and Interactive Play

WhiteWater understands water and play; we've built our business to be a world leader in waterpark and attractions rides based on our expertise. Our name is recognised as a premier designer, manufacturer and supplier of rides and attractions to the best water and theme parks in the world.

We've been designing and manufacturing rides for over 35 years, helping our clients create exhilarating experiences for their guests every day. We partner with our clients to help them develop world-class parks and attractions, supporting them every step of the way from park design, ride customisation and safety simulations, to local manufacture (at one of six global sites) and expert installation supervision.

We know our clients want the reassurance and convenience of working with a single expert supplier who can service their project from concept to completion. Which is why our company has grown to over 650 extremely talented professionals in 23 offices around the world, proud of each of the nearly 6000 WhiteWater sites around the world. It is our employee dedication which has made us a recurrent recipient of Canada's Best Managed Companies designation for excellence in management and business practices.



### Distinct Experiences

Our play psychologists understand kids and play. As a result we are able to create the most innovative experiences seen in our industry to help differentiate your park from the competition.

### Design Services

Our team of Architects and Designers know how to integrate attractions and services in a way that maximizes guest experience and drives your return on investment.

### Engineering

Safety and reliability are a focus for WhiteWater. The knowledge WhiteWater has developed over 35 years in the Waterpark industry is applied to every project.

### Customization

We maintain our own key services to maintain quality and meet any need you have. We will create a unique and tailored solution to help you achieve your revenue and operational goals.

### Global Presence, Local Knowledge

We source globally, speak in your language and are there with you as your partner every step of the way. We understand your concerns and limitations, working with you to deliver the highest quality product and service. With offices all over the world we understand the industry and develop best practises.



# MEET OUR TEAM

**Erika Kulbach**  
Specialist, North America

*With a Masters in Architecture, Erika leverages her design expertise to provide integrated solutions for you. She is collaborative and works hard to ensure you understand the solutions best suited to you.*



**Jim Glover** | Water Ride Expert

*As a longtime employee of Hopkins Rides, Jim brings a wealth of knowledge to you about water rides and the amusement industry. Having worked in all aspects of the business from design through operations he offers invaluable advice.*

**Tania Bayona**  
Specialist, South America

*With extensive experience in international business development and project management, Tania can help you drive revenue. With a unique understanding of the South American market she will be there to guide you.*



**Dan Seguin** | Water Ride Engineer

*As an industry enthusiast, Dan channels his passion into producing optimal experiences for your guests.*

**Rick Briggs** | Product Innovator

*Known as the grandfather of interactive water play, Rick is also the proud inventor of Foam Factory® and Ballocity™ products. He is a visionary of the attractions industry and is currently working on his next innovation.*

**38 YEARS**  
of experience



**50+**  
patents

**38 YEARS**  
of experience



**8**  
patents

**Mark Weston** | Playologist

*With a Masters in Social Psychology, Mark has integrated his creativity with knowledge of play for children's products. For years, he acted as a consultant for family focused entertainment companies including: Hasbro Interactive, PlaySkool and Walt Disney Imagineering.*

**29 YEARS**  
of experience



**21 YEARS**  
of experience



**Doug Smith** | Attractions Expert

*Doug's expertise is a result of working with the leading companies producing family entertainment products. His understanding of operations and facility programming will help you develop and maximize your facility.*

**Anthony Marinakis** | Landscape Architect

*Anthony has master planned hundreds of the world's leading parks and facilities. Envisioning the application of your theme or IP brand, he brings the story to life, generating experiences that inspire your guest's imagination.*

**20 YEARS**  
of experience



**Lavender Zhang** | Specialist, China

*Lavender comes to WhiteWater Attractions after working with Overseas Chinese Town (OCT) Holding Company having supported OCT Shanghai Happy Valley in becoming one of the most thriving parks in the region.*



**Mike Rigby** | Specialist, Middle East

*Mike will help you drive your competitive advantage. With a Masters in International Business, he understands the attractions industry. Let Mike help you determine the attraction mix that will WOW your guests.*

Our team of experts is always here for you.  
WhiteWater is proud to have the best in-house team of experts including:

- 17 Project Managers
- 38 Engineers
- 10 Architects
- 76 Designers





## DESIGN SERVICES

*Decades of industry experience!*  
Through a meticulous design process, beginning with a detailed design workshop, WhiteWater Attractions' experts take into great consideration facility programming, traffic flow, entertainment value, budget, theming and much more in order to maximize your return on investment. Large or small, we know how to help you maximize your venue.

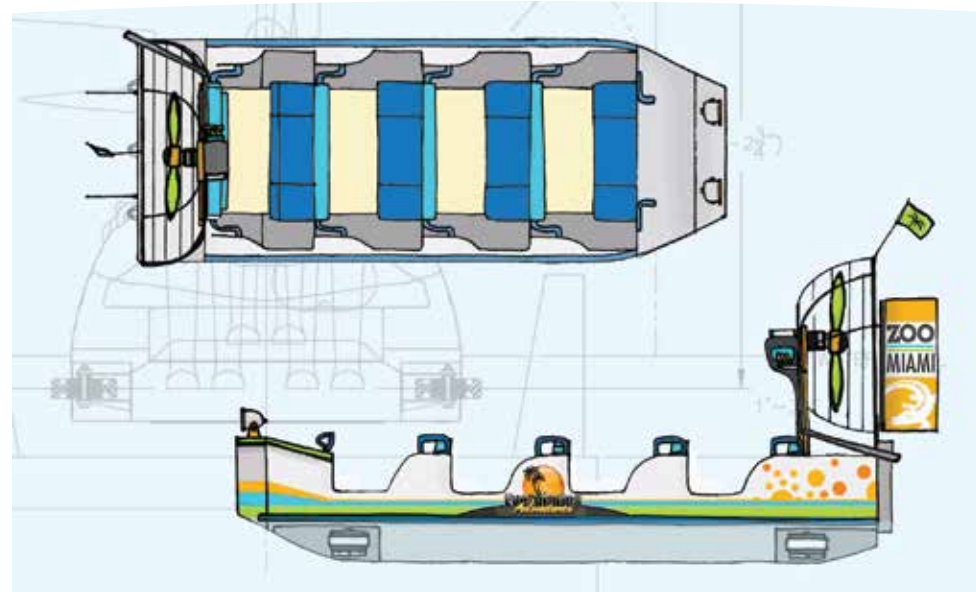
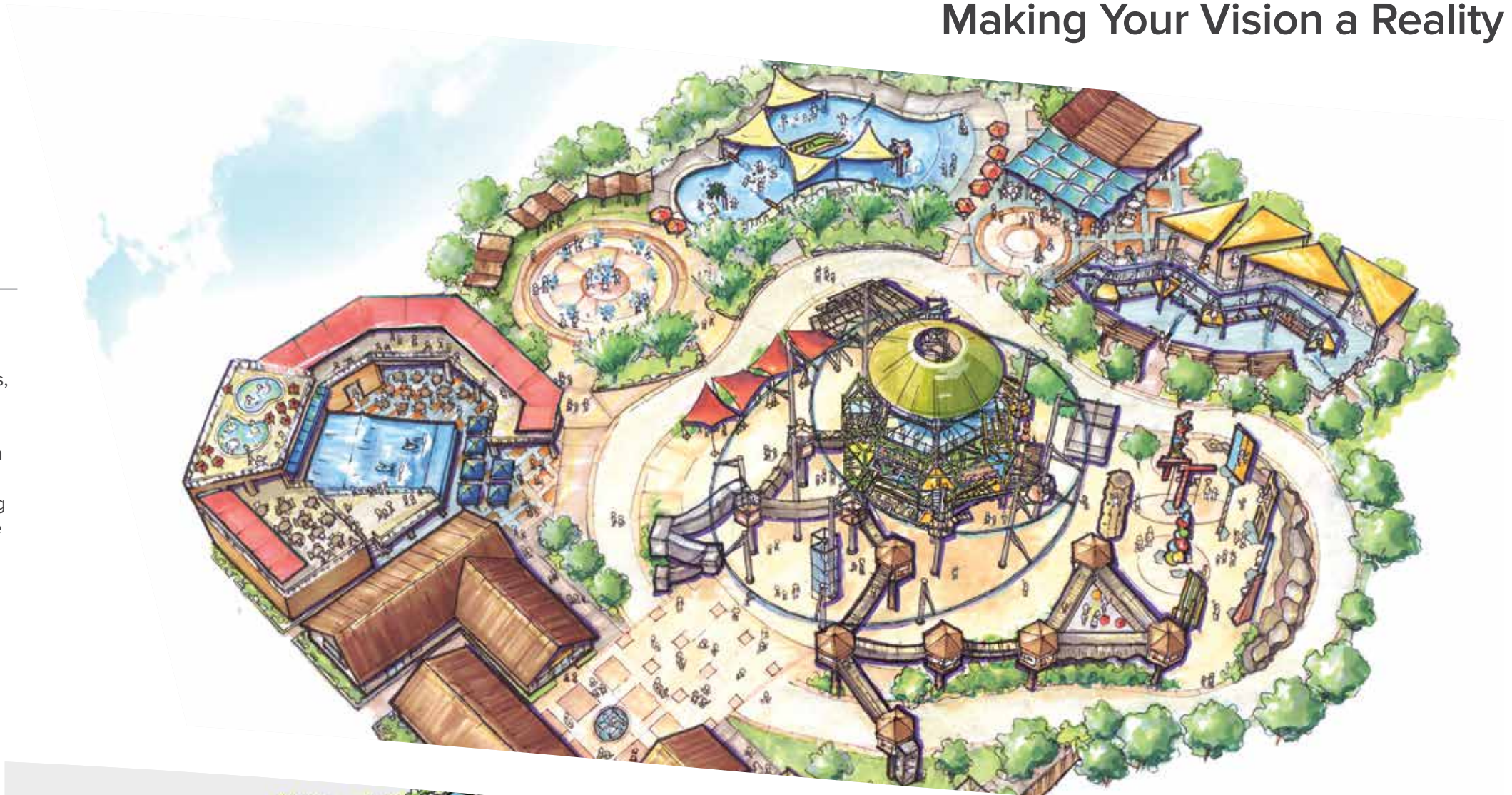

Custom boat design for Zoo Miami, Miami, Florida



Park planning



we understand your  
**GUEST'S BEHAVIOUR**

Concept drawing

**Design Workshops**  
A Designer and/or Architect is sent to work with your team directly over the course of 1 to 3 days. Understanding your vision, walking the site and discussing best practices, our team guides you to achieve the best return on your investment. You can look forward to development of the facilities program and an initial concept plan for the overall park. It is our goal to engage the imagination and excite you about what lies ahead.





## THEMING

*Create a truly immersive experience!*

Let WhiteWater's design professionals create your custom theme for any attraction. Our in-house team of experts is just the beginning of our commitment to quality and attention to every detail to produce the best product available in the market today. Our artists skillfully hand sculpt your thematic elements bringing the attraction to life.

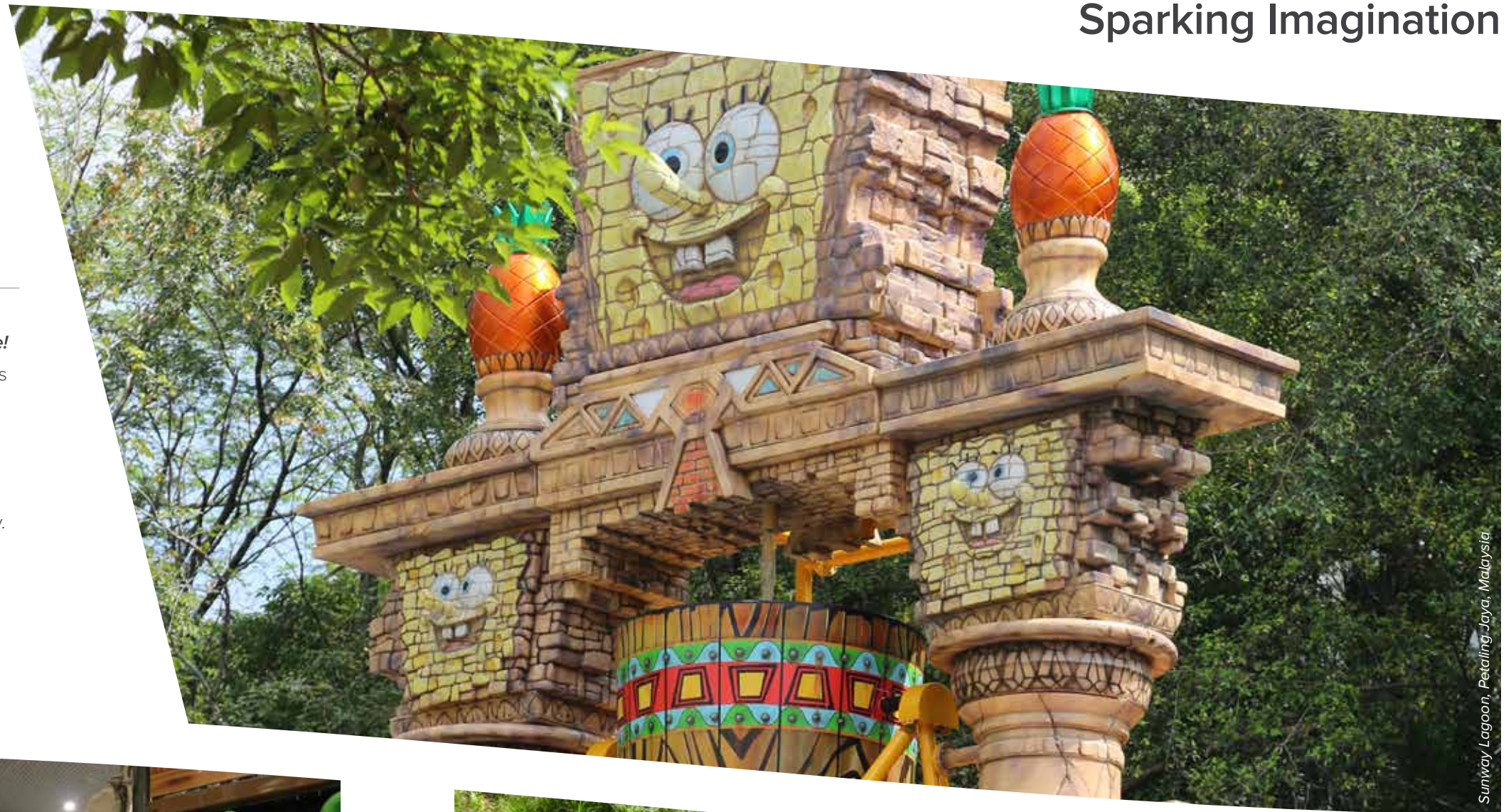

Sumway Lagoon, Petaling Jaya, Malaysia



**CREATE A JOURNEY**  
for your guests to get lost in



**INDOOR AND OUTDOOR**  
durable and awe inspiring



make anyone feel  
**LIKE A KID AGAIN**



captivate with a  
**UNIQUE STORY**



Our most popular existing themes include:

Licensed Brands  
Treehouse  
Underwater

Circus  
Egyptian  
Jungle  
Pirate Shipwreck



# Interactive Play

WE UNDERSTAND PLAY

Conceived and built on principles from our play psychologists, we understand how both kids and adults play. With attention to details both large and small, we ensure your guest's experience is memorable. Igniting imagination is what we do best.

Unique one-of-a-kind products help you differentiate your park. With the utmost attention to safety, our attractions are designed to last. Keep them happy for hours, letting their imaginations run, as they explore our play structures.





## ADVENTURE TRAIL

*An ideal combination of exploration and safety!*

The Adventure Trail lets the whole family explore together, criss crossing between soaring towers, rope bridges, climbs and slides. Encourage active play with multi-level exploration and discovery by engaging guests both physically and mentally. Attracting a wide demographic, Adventure Trail is ideal for amusement parks, resorts, zoos, waterparks, hotels and aquariums.



Sea World Gold Coast, Gold Coast, Australia



**DOUBLE CAPACITY**  
by maximizing your site using the vertical height space



**MINIMAL STAFFING**  
requirements

Sea World Gold Coast, Gold Coast, Australia

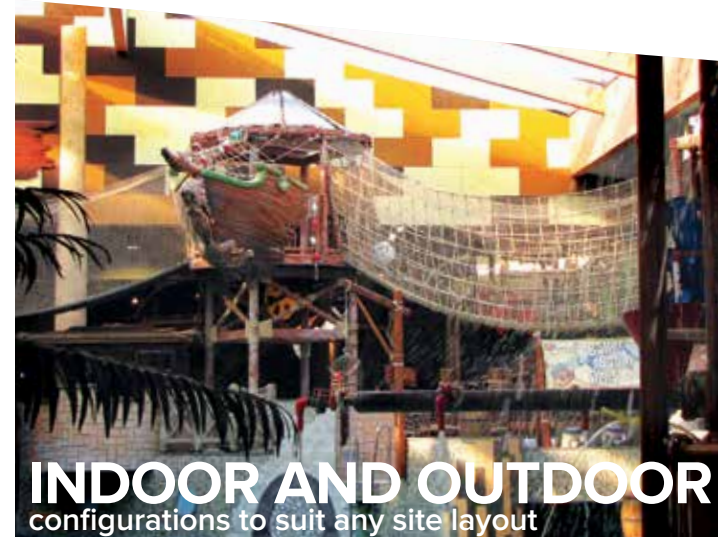

**INDOOR AND OUTDOOR**  
configurations to suit any site layout

Aquapulco, Bad Schallerbach, Austria



**IGNITE IMAGINATION**  
through storytelling and branded or IP theming

Stone Mountain Park, Stone Mountain, Georgia

All systems are custom designed to specific site and budgetary requirements

**Operators Needed\***  
1 - 2  
\* Dependent upon design and local legal code requirements

**Hourly Throughput**  
up to 2400 guests

**Instantaneous Capacity**  
up to 850 guests

**Maximize Site Efficiency**

Facilities can maximize their available space by expanding vertically, using an elevated attraction. The area below the Adventure Trail can be used for food and beverage, pools, lazy rivers and other attractions!

\* Applies to all instance of Operators needed



**NEW!**

## NO BOUNDARIES™

### *Revolutionizing the industry!*

No Boundaries™ is an innovative iconic attraction offering high thrill and high challenge activities for guests of all ages and skill levels. Our team of Play Psychologists have expertly integrated different ways to play within one attraction creating an unforgettable, never before seen experience. No Boundaries offers more than four different activities within one compact footprint, enabling families to play alongside each other while doing different things - keeping everyone happy and occupied! Differentiate your park and drive attendance by being one of the first to offer No Boundaries to your guests.

With an industry changing visual presence, No Boundaries combines elements and activities for harnessed and unharnessed participants. Weaving together a challenge course with uphill climbs, downward descents and a winding aerial zip coaster into a one-of-a-kind spectacular adventure park for the whole family.

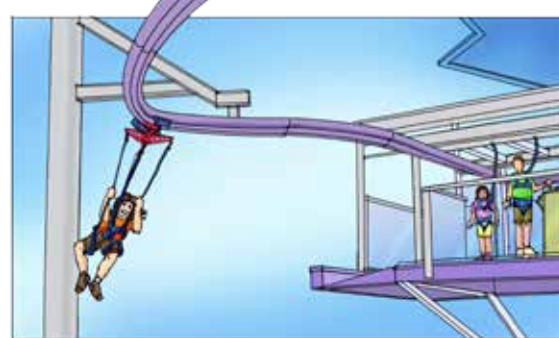

No Boundaries is available in multiple sizes, for both indoors and outdoors

Engineered by our dedicated team of experienced Engineers, whose dedication ensure your guests have the safest, highest quality experience possible.



# Water Rides

## THE WATER FUN EXPERTS

With patented technology we create exciting, unexpected experiences from tummy-turning drops and high speed rapids to spinning vortexes, all in your street clothes with just the the right amount of splash.

WhiteWater has built upon O.D. Hopkins Rides by revitalizing theme park favorites with fresh new ride paths. We have a full portfolio of solutions for every venue type. By combining our focus on safety with our heritage of world class manufacturing we provide water fun to millions of people around the globe.





An Essential Element in the World's Best Parks



## LOG FLUME

*The industry classic!*

The Log Flume ride is a timeless attraction featured in popular venues all over the world. Combining water elements with an amusement park ride brings the best of two worlds together for one splashy experience. Our water flow technology keeps the ride exciting from start to finish. A time tested recipe for family fun!



Parc Astérix, Plailly, France



caters to a wide **DEMOGRAPHIC**

Calaway Park, Calgary, Alberta

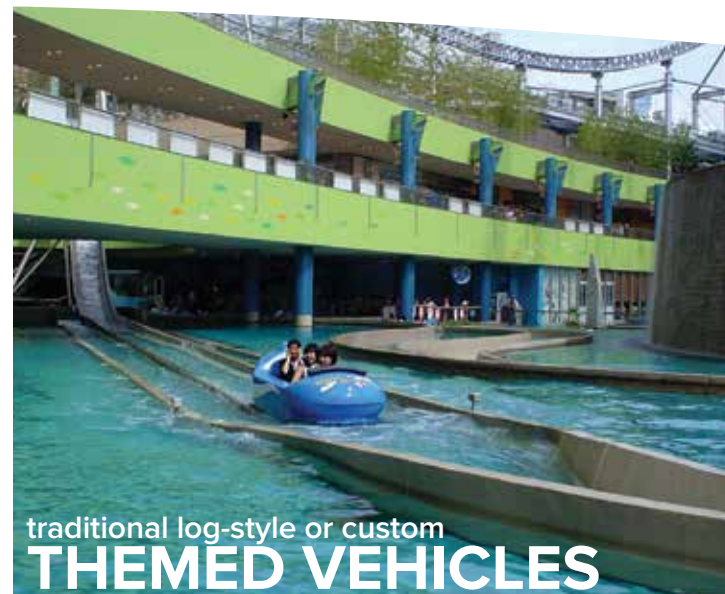

traditional log-style or custom **THEMED VEHICLES**

Tokyo Dome City, Tokyo, Japan



straight through station with continuous **LOADING CONVEYOR**

Enchanted Kingdom, Santa Rosa City, Philippines



making guests smile **FOR OVER 50 YEARS**

Mall of America, Bloomington, Minnesota

Vehicle Capacity  
4 guests      Hourly Capacity  
up to 1000 guests



Over 30 Installations Worldwide!

- Japan
- Mexico
- South Africa
- Phillippines
- USA
- Canada
- UAE
- ...and more!
- France



Outperform Traditional Roller Coasters for a Fraction of the Price

# SUPER FLUME

*Family friendly excitement!*

The Super Flume is the larger cousin of the popular Log Flume. Featuring boats that hold up to eight passengers, the Super Flume's increased capacity can accommodate a large number of guests and help keep lines moving quickly. Integrate narrative to take your guests on a more immersive journey. The Super Flume is a family-friendly attraction with a fun filled ride finishing with a splash!



Dollywood, Pigeon Forge, Tennessee



**SURPRISE GUESTS**  
with a sudden direction change

Everland Theme Park, Yongin, South Korea



**MONUMENTAL**  
drops up to 20m (66ft)

Warner Bros. Movie World, Gold Coast, Australia



**SUITS ANY SITE**  
and project budget

Dollywood, Pigeon Forge, Tennessee



in-ground or **ELEVATED TROUGHS**

Discovery World, Taichung, Taiwan

Vehicle Capacity  
8 guests

Hourly Capacity  
up to 1000 guests



Engineered with steel tree support structure to save on costs and minimize footprint



## SHOOT THE CHUTE

*A splashing thrill for the whole family!*

This modernized version of a must-have amusement attraction offers a thrilling drop followed by the most important element, a spectacular iconic splash. This feature has made Shoot the Chute rides a centerpiece at world-renowned theme parks and waterparks, globally. No one makes as large a splash as we do.



LEGOLAND® California Resort, Carlsbad, California



**HUGE CAPACITY**  
up to 20 people per boat

*Dunia Fantasi, Ancol, Indonesia*



**BREATHTAKING**  
drops add thrill and excitement

*Concept Rendering*



**FLEXIBLE DESIGN**  
for either theme park or waterpark application

*Noah's Ark Water Park, Wisconsin Dells, Wisconsin*



**world-renowned CLIENTS**

*Thorpe Park, Chertsey, UK*

Vehicle Capacity  
12 or 20 guests

Hourly Capacity  
up to 1600 guests



Refresh your guests with the iconic giant splash, or integrate AquaSpray™ elements on the sidelines for some unexpected interactive water fun.



# Conquer the Roaring High Speed Rapids



## RIVER RAFT RIDE

*A genuine "WhiteWater" rafting experience!*

Park guests will enjoy this wild ride as they are splashed as their rafts negotiate the course to encounter turbulent waters, quiet pools, dark tunnels, and near-miss waterfalls! Our experts have engineered the water flow to simulate a genuine river rapids rafting experience, all with minimal mechanical requirements for your operations team.



Lake Compounce, Bristol, Connecticut



**EXCITING SENSATIONS**  
within a safe environment

Enchanted Kingdom, Santa Rosa City, Philippines



share the whitewater rafting experience for a **FAMILY THRILL**

Ancol, Jakarta, Indonesia



enhance and emphasize your **LOCAL LANDSCAPE**

Enchanted Kingdom, Santa Rosa City, Philippines



**FREE-FLOWING RIVER**  
allows for a unique experience each time

Enchanted Kingdom, Santa Rosa City, Philippines

Vehicle Capacity  
8 guests      Hourly Capacity  
960 - 1440 guests

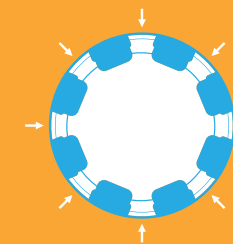

Unique raft with eight sided entry leads to faster load time and higher throughput





## WATER TRANSPORTATION SYSTEMS

*Become immersed in the journey!*

A Water Transportation System provides a relaxing voyage that allows guests to immerse themselves in the story of your park. The leisurely boat ride can provide unique transportation and circulation by weaving through exhibits, gardens or themed landscapes of your park. Make getting from A to B part of the experience with flexible boat and theming options.



Columbus Zoo, Columbus, Ohio



provide guests with a **NEW PERSPECTIVE**

Gilroy Gardens, Gilroy, California



boats available in many sizes, **SHAPES AND THEMES**

Columbus Zoo, Columbus, Ohio



a proven attraction for **GREAT STORYTELLING**

Columbus Zoo, Columbus, Ohio



**A FAMILY ATTRACTION**  
suitable for all ages to enjoy together

Gilroy Gardens, Gilroy, California

Vehicle Capacity  
4, 8 or 20 guests

Hourly Capacity  
up to 800 guests

Light or Dark?

The Water Transportation System is suitable for indoors and outdoors. Make it into a dark ride to provide your guests with an added element of thrill.



# Patented Propulsion Technology Creates a Spinning Vortex

## SPINNING RAPIDS® RIDE

*No other ride like it in the world!*

Differentiate your park with this one-of-a-kind waterslide attraction guests can enjoy in their street clothes. Centrifugal forces press riders against the back wall of rafts as they swiftly spiral down the flume providing an intense, heartpounding ride experience. Family-sized rafts are propelled into silly spins, tummy-tightening turns and dramatic drops, without getting riders completely soaked!



Adventureland, Altoona, Iowa



**THE IDEAL BALANCE**  
of low maintenance and high capacity

Cypress Gardens, Winter Haven, Florida



**VARIATIONS AVAILABLE**  
with reduced footprint, smaller flume and unique exit paths

Hansa Park, Sierksdorf, Germany



**CONVEYOR SYSTEM**  
carries rafts and guests to the ride launch area

Thorpe Park, Chertsey, England



**ENGINEERED**  
to soak guests just the right amount

Six Flags America, Upper Marlboro, Maryland

**Patented Technology**

US5716282 A; DE69725993 D1; EP0921845 A1;  
EP0921845 A4; EP0921845 B1; WO1998001199 A1



**Vehicle Capacity**

3 - 6 guests

**Hourly Capacity**

700-1200 guests

By taking our tried-and-true waterslide expertise and adapting it to theme parks, we offer your guests splashes without the need for a bathing suit. Adding a fiberglass amusement attraction provides a visual differentiator for your park or facility, reducing mechanical requirements and increasing colour options.



A Year Round Guest Favourite  
All Over The World

## WATER COASTER®

### High thrill waterslide fun!

An action-packed ride offering twists, turns and drops through high banking curves and exhilarating accelerations. Offer your guests two distinct ride experiences from one compact ride complex with the excitement of a waterslide while remaining in their street clothes. The specialized shutdown lane de-waters the landing area, preventing riders from being soaked. Enhance your park's offering with this unique attraction.



Universal Studios, Orlando, Florida



**INTEGRATED CONVEYOR**  
so guests never have to do any heavy lifting

Canobie Lake Park, Salem, New Hampshire



we are the largest global manufacturer of  
**WATERSLIDES**

Universal Studios, Osaka, Japan



**ADD AQUALUCENT™**  
rings for dramatic visual effects



**CHILL OR THRILL**  
with versatile engineered slide paths

Cypress Gardens, Winter Haven, Florida

Vehicle Capacity  
2 guests

Hourly Capacity  
up to 500 guests



Evolve your Water Coaster® into an interactive game!

Slideboarding integrates gaming, skill, edge, and competitive sports into an experience that will define amusement experiences of the future.

For more information visit  
[slideboarding.com](http://slideboarding.com)



**NEW!**

## RAFT BATTLE

*The most interactive river ride in the industry!*

WhiteWater Attractions' newest innovation, Raft Battle, is a fully interactive adventure themed river ride offering unexpected thrills and excitement to riders and spectators alike. Aboard round rafts armed with water cannons, riders and spectators take aim at targets and each other while traveling along a scenic and free-flowing river.

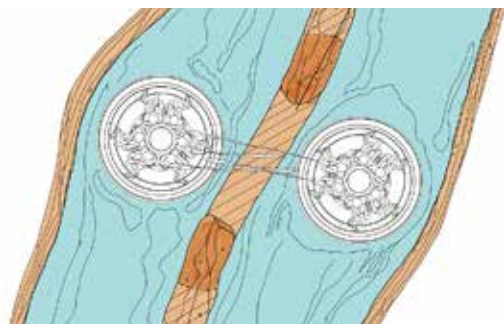

Speeding around corners reveal water battle zones

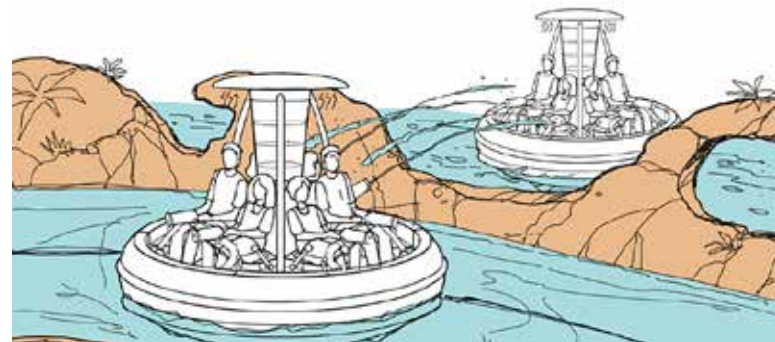

360° interactivity



Elevate the excitement and mischief between rafts and spectators



Base vehicle ready for theming

Vehicle Capacity  
6 guests

Hourly Capacity  
up to 1028 guests

Interactive river ride features:

Automatic and Guest Activated Water Elements  
Soaring Geysers

Cascading Waterfalls  
Arching Jets



# SERVICE & MAINTENANCE

With safety as the top priority for every park, it is essential to be absolutely sure rides and attractions are maintained to the highest standards. At WhiteWater Attractions, our After Sales and Service department is dedicated to helping you maximize the lifespan of your attraction by providing all components of a Water Ride including boats, lifts, stations, electronic equipment, pumps and drive motors. **After time, indoor or outdoor play structures need some attention with inspections, minor repairs and replacement parts. WhiteWater's experts can identify any potential weakness within your structure and provide a detailed report on recommended maintenance and services. Additionally, a cost-efficient way to update or upgrade an existing play structure is by retrofitting it with interactive add-ons or custom theming elements.**

*WhiteWater is the authorized provider of Hopkins Rides spare parts.*



WhiteWater offers tested and approved Hopkins Rides OEM replacement parts, services for all Interactive Play structures, Harnessed Attractions, Koala Play, Delta Play, and Prime Play structures

## OUR SERVICES INCLUDE *(but are not limited to)*

- Ride inspections and troubleshooting
- Spare and replacement parts
- Replacement part installation services
- Attraction and ride vehicle maintenance
- Providing additional ride vehicles
- Play structure inspections
- Foam ball supply (for Ballocity™ and Foam Factory® structures)
- Play element replacement and repair
- Theming or retrofitting special features



**Protect the value of your investment with regular maintenance**



Visit

**[aftersales.whitewaterwest.com](http://aftersales.whitewaterwest.com)**  
for all your replacement parts including water rides parts, Hopkins Rides parts, contained play netting, tube sections, foam tuffcoat, pull ties and much more.



WhiteWater is the world's largest designer and manufacturer of a complete range of rides and attractions for the waterpark and attractions industries. We are known for the high quality of our waterslides, wet interactive play structures and every type of wave including FlowRider® stationary surf machines. Our harnessed play, multilevel play structures and water rides share the same heritage, strong reputation and the same attention to detail. From concept to completion our expert designers and project managers work with clients to deliver Wow experiences. With 23 offices around the world WhiteWater is always close by with local knowledge and support.



**Corporate Head Office**

WhiteWater West Industries Ltd.  
6700 McMillan Way  
Richmond BC V6W 1J7 Canada  
  
+1.604.273.1068  
whitewater@whitewaterwest.com  
  
whitewaterattractions.com

**Global Sales Offices**

**Canada**  
British Columbia  
Ontario

**USA**  
California  
Colorado  
Florida  
Arkansas  
Ohio  
Wisconsin

**Global**  
Australia  
China  
Colombia  
Egypt  
India  
Korea

**Global**  
New Zealand  
Puerto Rico  
Russia  
Spain  
Thailand  
UAE  
United Kingdom



Explore our full range of products:



WhiteWater's After Sales & Service department is dedicated to helping its customers maximize the lifespan of their attractions. [aftersales.whitewaterwest.com](http://aftersales.whitewaterwest.com)